

Specifications

Current rating:7A AC,DC
Voltage rating:250V AC,DC
Temperature range:-40°C~+105°C
Contact resistance:10mΩMax.
Insulation resistance:1000MΩMin.
Withstanding voltage:1500V AC/minute
Compliant with RoHS and REACH
Meet the HF/Halogen Free,GWT/Glow wire Test (IEC60335-1) request,need to customize
Contact CJT for details

Standards



Assembly layout

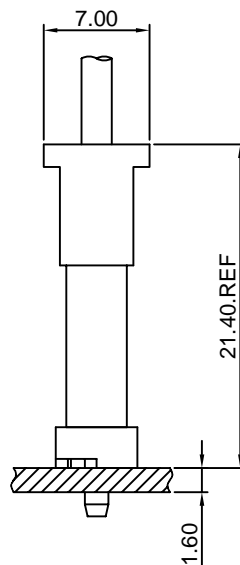

A1561-T

7.50-5.00mm pitch Crimp Terminal

Reference Informations:

* Used in CJT A1561 series Housing

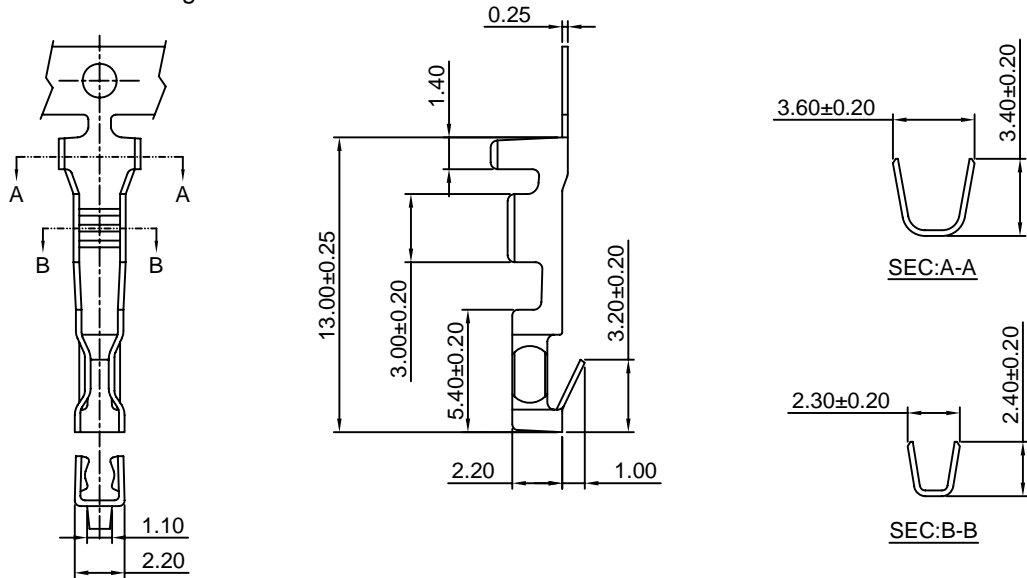

Ordering information & Specifications:

Unit:mm

Part NO.	Wire Range	Insulation O.D.	Material	Finish	Qty/reel
A1561-TB	AWG#18-#24	2.70mm(max)	Brass	Tin over Nickel	6,000 PCS
A1561-TP	AWG#18-#24	2.70mm(max)	Phosphor Bronze	Tin over Nickel	6,000 PCS
A1561-GB	AWG#18-#24	2.70mm(max)	Brass	Gold over Nickel	6,000 PCS
A1561-GP	AWG#18-#24	2.70mm(max)	Phosphor Bronze	Gold over Nickel	6,000 PCS

Optional Gold plating available but MOQ requested

A1561H

7.50-5.00mm pitch Housing

Reference Informations:

*Material:Nylon 66,UL94V-0

*Suitable CJT A1561 series Terminal

*Mates with CJT A1561 series Wafer

*Color:White

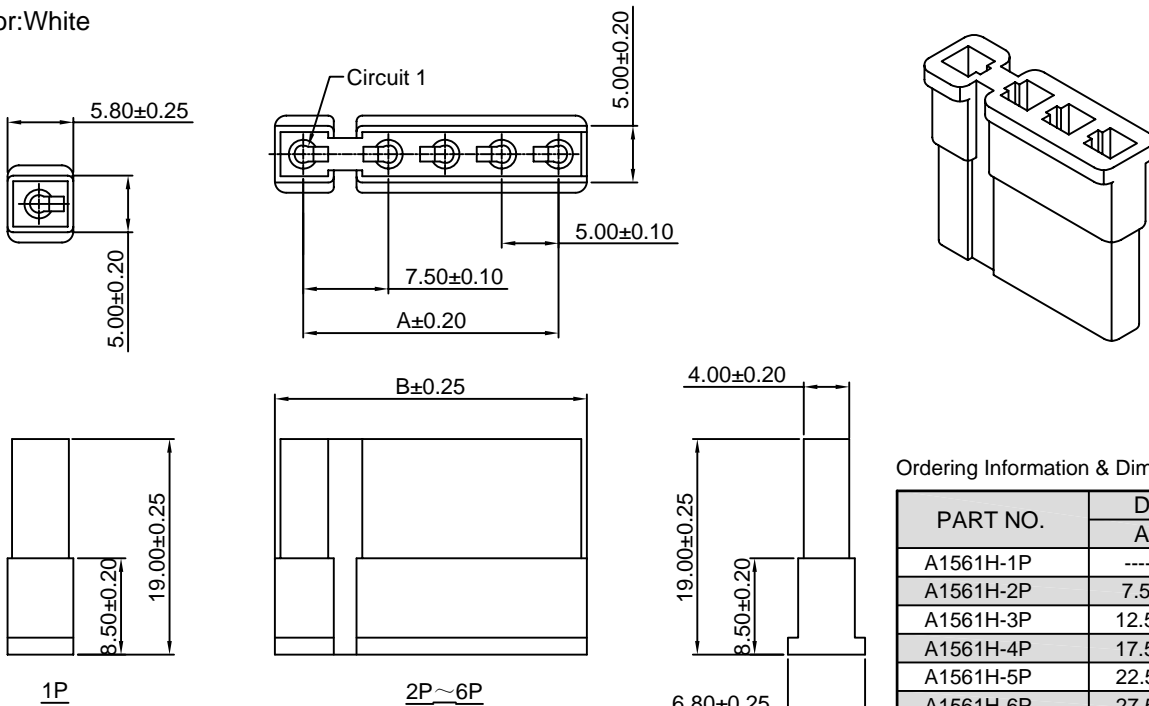

Ordering Information & Dimensions

PART NO.	Dimensions	
	A	B
A1561H-1P	-----	5.80
A1561H-2P	7.50	12.50
A1561H-3P	12.50	17.50
A1561H-4P	17.50	22.50
A1561H-5P	22.50	27.50
A1561H-6P	27.50	32.50

Unit: mm

A1561HA

7.50-5.00mm pitch Housing

Reference Informations:

- *Material:Nylon 66,UL94V-0
- *Suitable CJT A1561 series Terminal
- *Mates with CJT A1561WVA series Wafer
- *Color:White

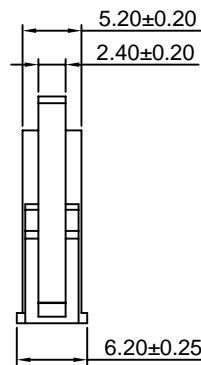
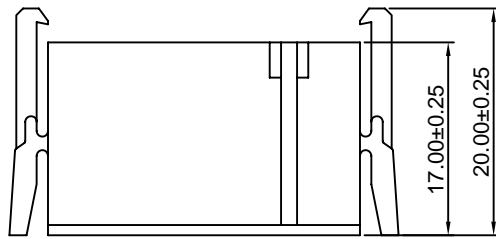
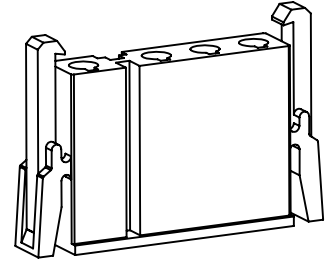
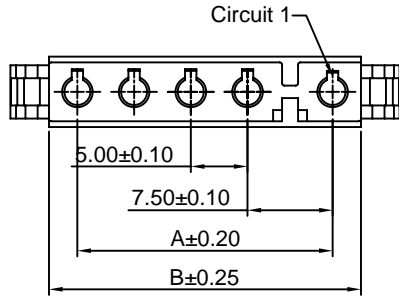

Ordering Information & Dimensions

PART NO.	Dimensions	
	A	B
A1561HA-2P	7.50	12.50
A1561HA-3P	12.50	17.50
A1561HA-4P	17.50	22.50
A1561HA-5P	22.50	27.50
A1561HA-6P	27.50	32.50

Unit: mm

A1561WV

7.50-5.00mm pitch 180° Wafer

Reference Informations:

- *Material:Pin:Brass/Tin over Nickel
Insulator:Nylon 66,UL94V-0
- *Mates with CJT A1561 series Housing
- *Color:White

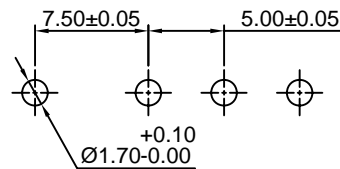
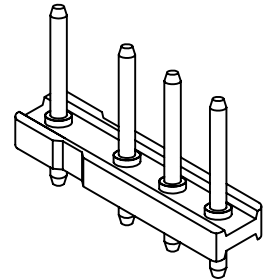
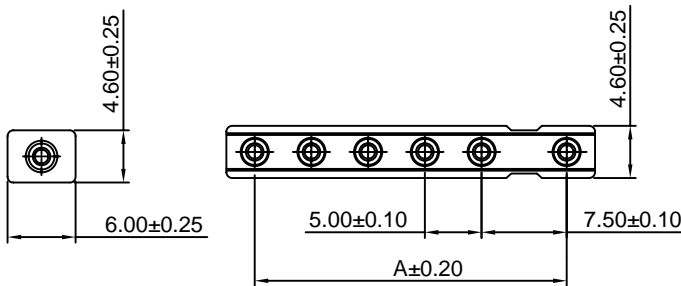

P.C.B LAYOUT

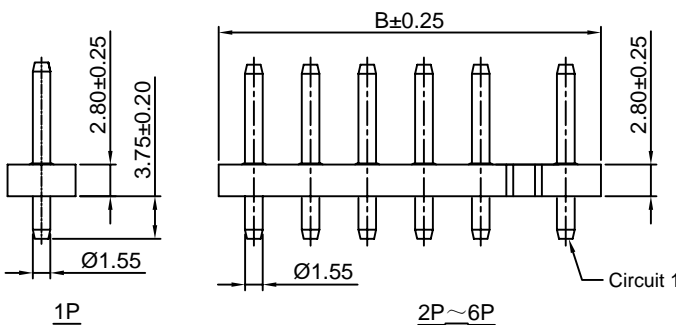

Ordering Information & Dimensions

PART NO.	Dimensions	
	A	B
A1561WV-1P	---	6.00
A1561WV-2P	7.50	12.60
A1561WV-3P	12.50	17.60
A1561WV-4P	17.50	22.60
A1561WV-5P	22.50	27.60
A1561WV-6P	27.50	32.60

Unit: mm

A1561WVA

7.50-5.00mm pitch 180° Wafer

Reference Informations:

- *Material: Pin: Brass/Tin over Nickel
Insulator: Nylon 66, UL94V-0
- *Mates with CJT A1561HA series Housing
- *Color: White

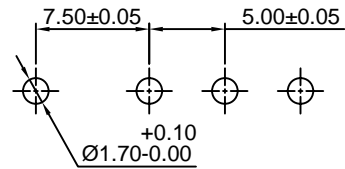
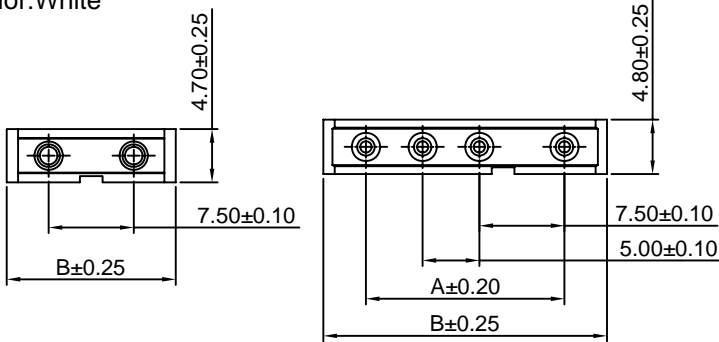
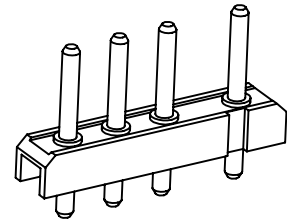

P.C.B LAYOUT

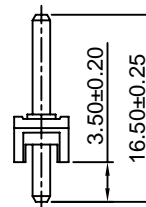
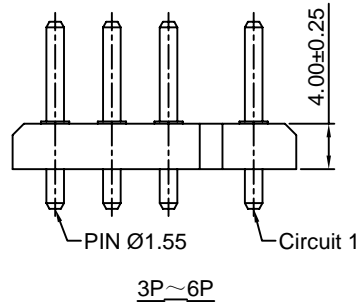
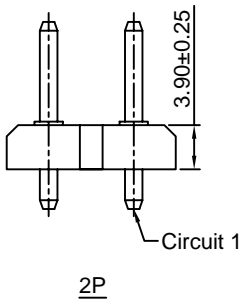

Ordering Information & Dimensions

PART NO.	Dimensions	
	A	B
A1561WVA-2P	7.50	14.90
A1561WVA-3P	12.50	20.00
A1561WVA-4P	17.50	25.00
A1561WVA-5P	22.50	30.00
A1561WVA-6P	27.50	35.00

Unit: mm